

VENT-N



5145889700 - VENT-100NK (220/240V50/60HZ) R6 - IN LINE DUCT FANS

In-line duct centrifugal fan, manufactured from high grade corrosion resistant pressed galvanized steel. Motor IP44, single phase, external rotor with thermal protector. Model VENT-100NK (220/240V50/60HZ) R6.

Theoretical Working Point

Airflow	-
Static Pressure	-
Temperature	20 °C
Altitude	0 m
Density	1.2 kg/m ³
Frequency	50 Hz
Voltage	1-230V-50Hz

Construction

Diameter	100 mm
Fan size	100
Weight	3.00 kg

Motor Characteristics

Number of poles	2
Motor Power	-
Voltage	1-230V-50Hz
Maximum absorbed current	0.3 A
IP Rating	IP44
Motor insulation class	F

Drawing

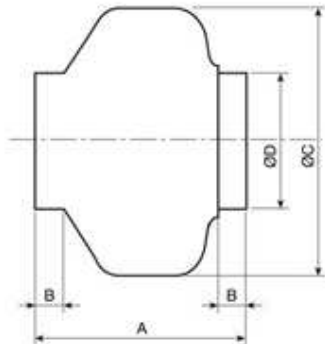

A	B	C	D
196	23	243	98

Performance Chart

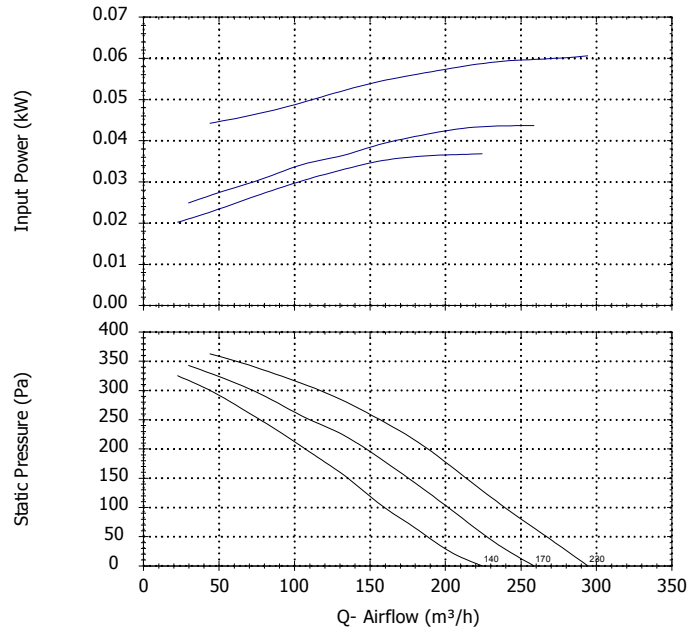

Sound Performance

	63	125	250	500	1k	2k	4k	8k	Overall
Inlet (LwA)	37	46	58	62	68	64	60	46	71
Inlet LpA @ 1m	26	35	47	51	57	53	49	35	60
Outlet (LwA)	37	43	57	56	60	57	52	42	64
Outlet LpA @ 1m	26	32	46	45	49	46	41	31	53
Breakout (LwA)	33	38	50	50	55	49	51	37	59
Breakout LpA @ 1m	22	27	39	39	44	38	40	26	48



VENT-N



5145889700 - VENT-100NK (220/240V50/60HZ) R6 - IN LINE DUCT FANS

Performance Chart

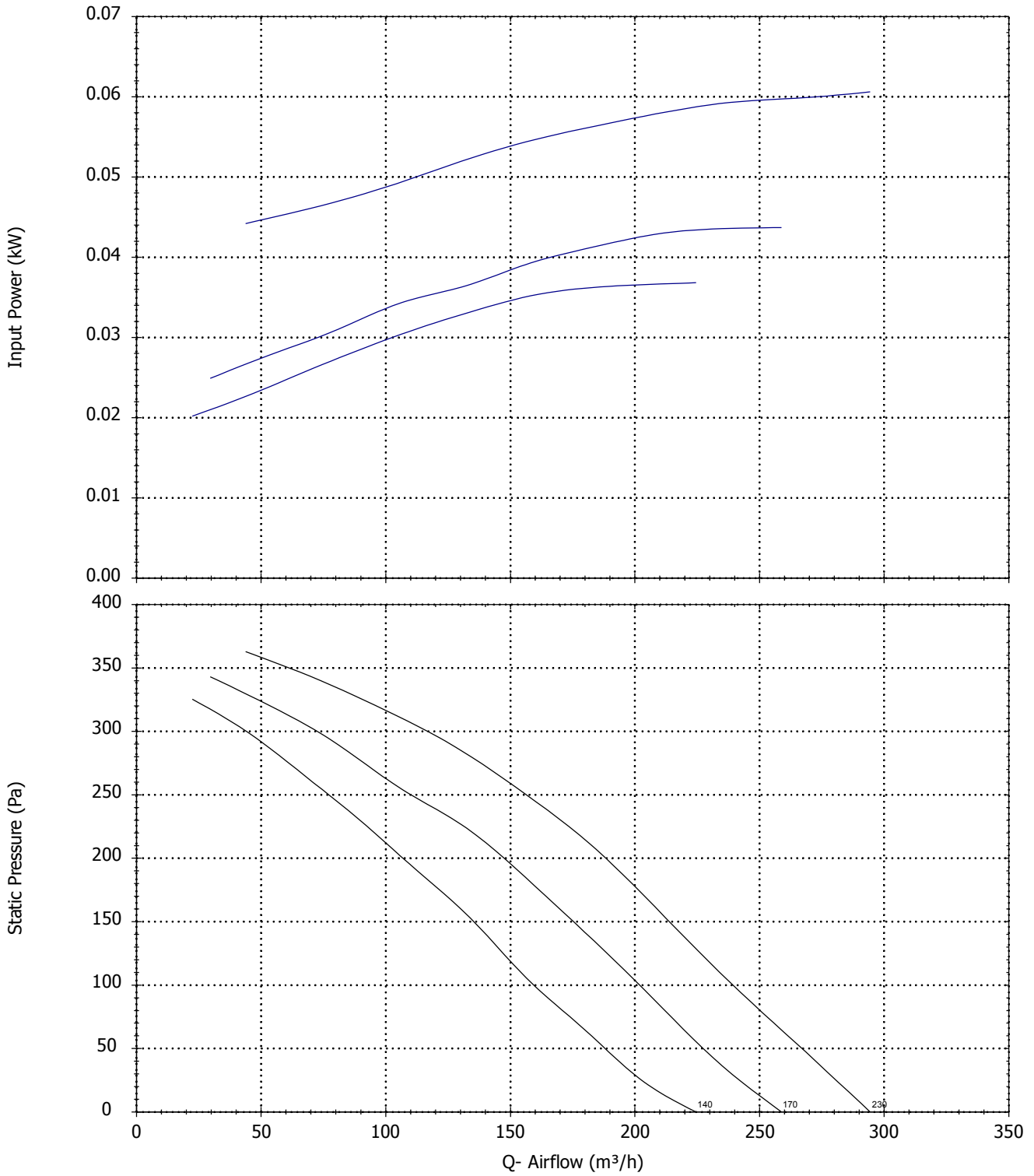



Drawing

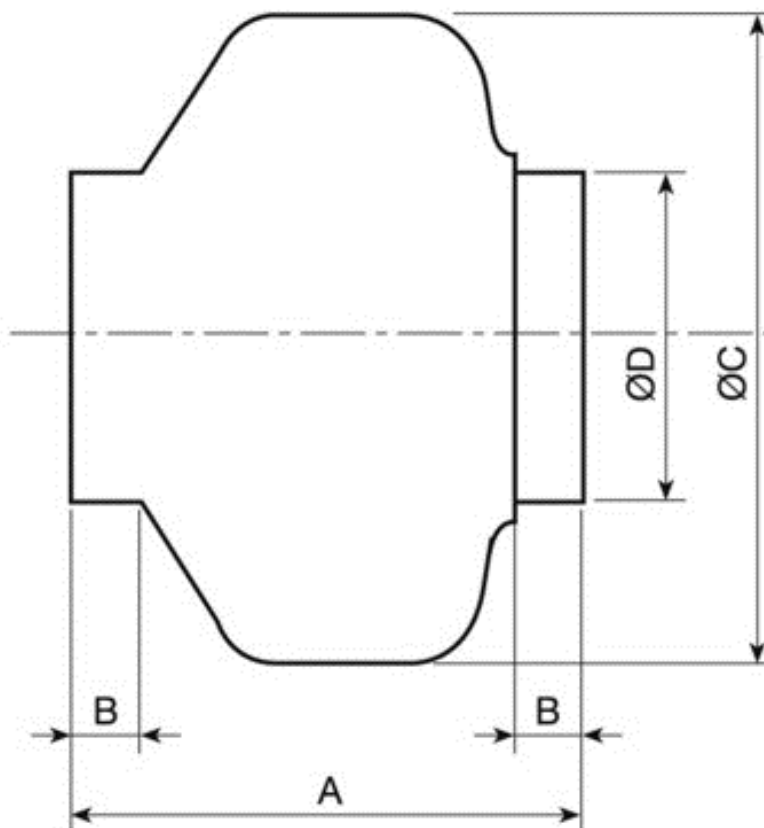

A	B	C	D
196	23	243	98



5145889700 - VENT-100NK (220/240V50/60HZ) R6 - IN LINE DUCT FANS

Accessories



5145819800 - ACOP-VENT-100 (V977501)
FLEXIBLE CONNECTOR



5416401700 - BOCA EXTRACCION BOC-100
inlet connector at the end of the duct

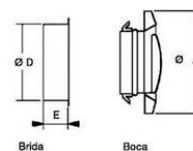

A	D	E
145	100	50



5416615200 - BORJ-100
Canopy



ØD1	ØD2	ØH	ØA	B	C
80	140	13	98	129	40



5416615300 - BORP-100
Isolation damper



ØD1	ØD2	ØH	ØA	B	H2
80	140	13	89	130	100



5416442100 - COMPUERTA ANTIRET.CAR-100
BACK DRAFT SHUTTER

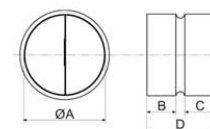

ØA	B	C	D
100	35	31	80

5416410800 - BRIDA FIJACION TUBO CX-80/125
WORM DRIVE DUCT CLIPS



\varnothing_{min}	\varnothing_{ma}
80	125

5145800800 - DEF-VENT-100
OUTLET WIRE PROTECTION GUARD

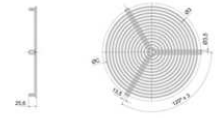

D
99

5209192000 - GSA-M0 100 10M
Flexible aluminium ducts made of a aluminium and polyester exterior covering a spiral steel wire frame. Used for general installations in detached or collective housing and commercial premises.

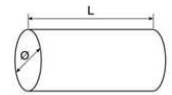

ϕ	L
100	10

5209150200 - GSA-M0 100 3M
Flexible aluminium ducts made of a aluminium and polyester exterior covering a spiral steel wire frame. Used for general installations in detached or collective housing and commercial premises.

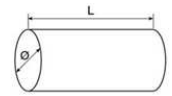

ϕ	L
100	3

5211800700 - MBE-100/04B
ELECTRIC HEATER BATTERY

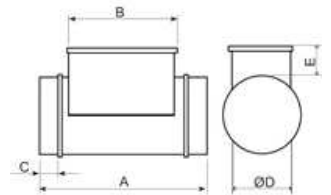

B	C	ϕD	E
278	42	100	105

5211780000 - MBE-100/04B-R 1/230V
ELECTRIC HEATER BATTERY

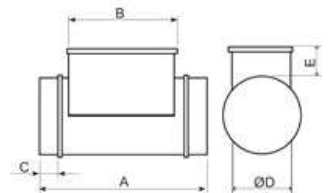

B	C	ϕD	E
278	42	100	105



5211808300 - MBE-100/08B 1/230V
ELECTRIC HEATER BATTERY

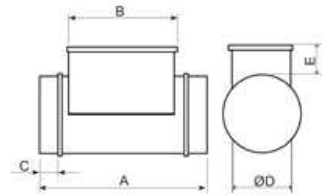

B	C	ØD	E
278	42	100	105



5211781000 - MBE-100/08B-R 1/230V
ELECTRIC HEATER BATTERY

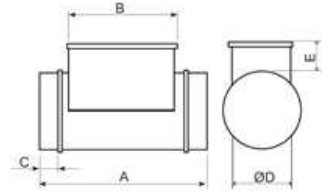

B	C	ØD	E
278	42	100	105



5132864000 - MBW-100

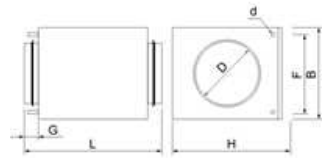

ØD	B	H	d	F	G	L
100	183	225	10	140	40	380



5416744600 - MFL-100 F
Box in galvanized steel for inserting the MFR F5, F6 and F7 filters. Fitted with inlet and discharge circular duct connection flanges with integrated rubber air seal and an inspection cover easy to open for maintaining the filters.

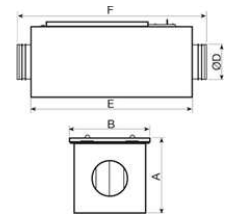

A	B	ØD	E	F
213	220	100	450	522



5416590700 - MFL-100 G4
IN-LINE FILTER BOX (G4 GRADE)

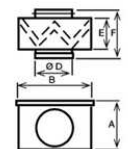

A	B	D	E	F
200	200	100	160	196



5416485000 - PLENUM RP-100
Terminal connector for GRI internal grille. The RP plenums are manufactured from galvanised sheet steel. Six diameters are available for corresponding GRI grilles.

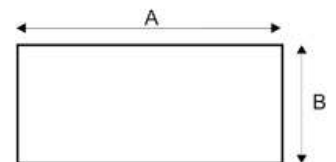

ØD	H	A	B	C	E
95	230	145	133	157	45

5211942100 - SIL-100

Silencer to be installed either at the inlet or outlet of the fan.



63	125	250	500	1k	2k	4k	8k
-1	-3	-9	-20	-28	-35	-28	-13



5145889700 - VENT-100NK (220/240V50/60HZ) R6 - IN LINE DUCT FANS

Sound Performance

	63	125	250	500	1k	2k	4k	8k	Overall
Inlet (LwA)	37	46	58	62	68	64	60	46	71
Inlet LpA @ 1m	26	35	47	51	57	53	49	35	60
Outlet (LwA)	37	43	57	56	60	57	52	42	64
Outlet LpA @ 1m	26	32	46	45	49	46	41	31	53
Breakout (LwA)	33	38	50	50	55	49	51	37	59
Breakout LpA @ 1m	22	27	39	39	44	38	40	26	48



Q=1